

Service Data

Vickers®

# Vane Pumps

---



## Double Vane Pump

4535VSH 42 A 25 F 412 \*\* 10



Revised 07-01-96

M-2520-S

CAPACITY (GPM) COVER END PUMP	● RING	● CARTRIDGE KIT
25	576210	860123
30	576212	860124
35	576214	860125
38	575476	860126

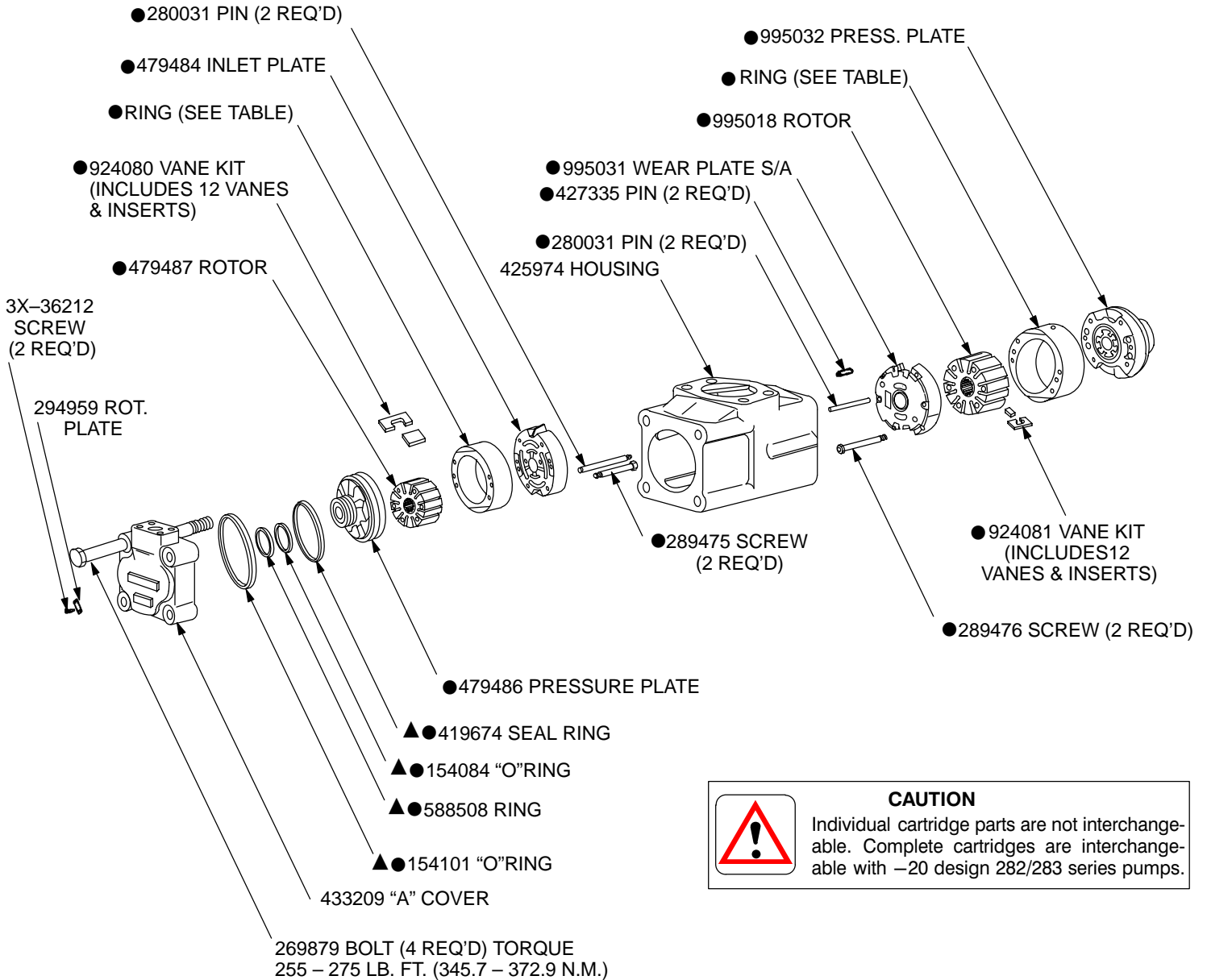

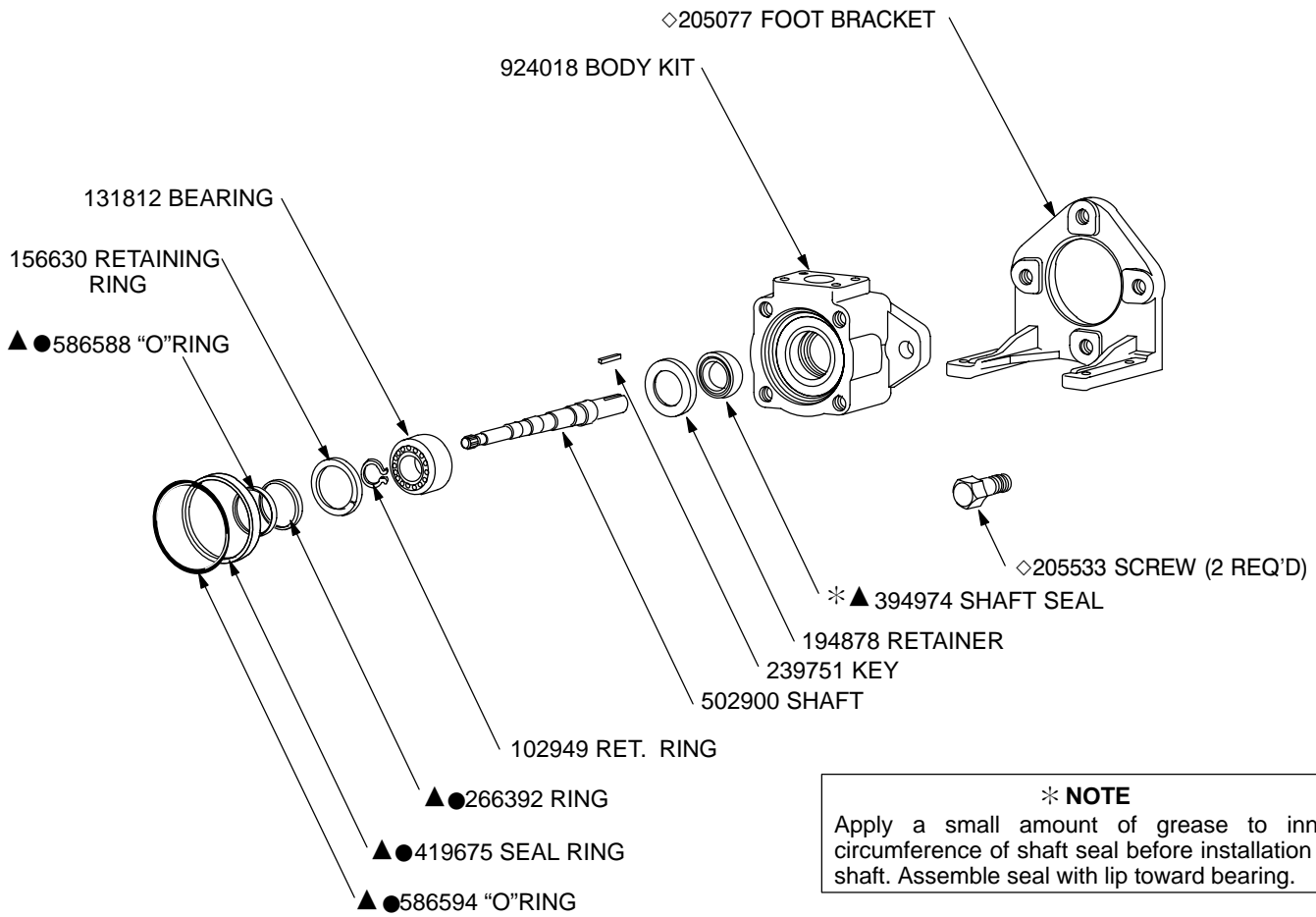

**CAUTION**  
 Individual cartridge parts are not interchangeable. Complete cartridges are interchangeable with –20 design 282/283 series pumps.

- INCLUDED IN CARTRIDGE KIT
- ▲ INCLUDED IN SEAL KIT 875840
- ◇ INCLUDED IN FB-C-10/12

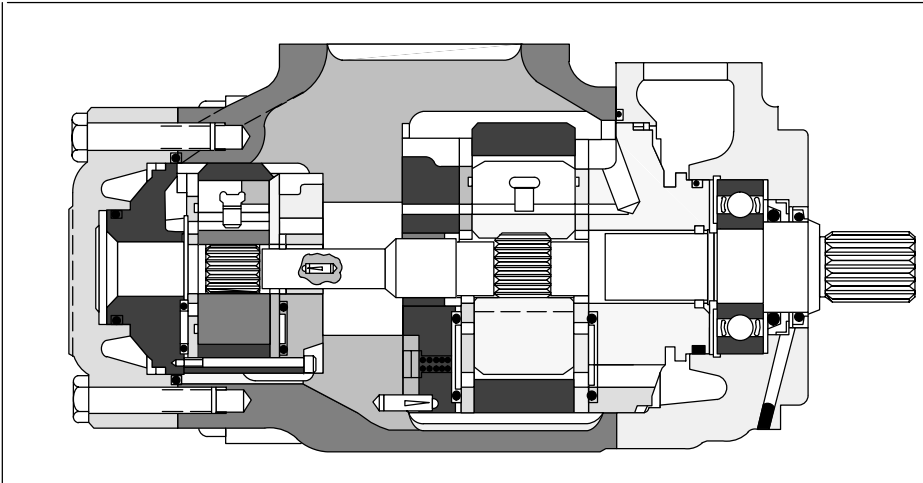

**\* NOTE**  
 Apply a small amount of grease to inner circumference of shaft seal before installation of shaft. Assemble seal with lip toward bearing.

CAPACITY (GPM) SHAFT END PUMP	● RING	● CARTRIDGE KIT
42	581679	995013
50	581680	995014
60	578904	995015



# MODEL CODE BREAKDOWN

**4535 VSH 42 A 25 F \*\*\* \*\* 10 L**

**1 2 3 4 5 6 7 8 9 10**

**1** Series  
(4535 Double Pump)

**2** Intra-Vane Pump  
(VSH Series)

**3** US GPM Capacity  
(Shaft End Pump)  
SAE Rating 1200 RPM-100 PSI (7 Bar)  
42 – 42 GPM    60 – 60 GPM  
50 – 50 GPM

**4** SAE Port Connections  
Code    Inlet    Outlet # 1    Outlet # 2  
A    4-Bolt Flg.    4-Bolt Flg.    4-Bolt Flg.

**5** US GPM Capacity  
(Cover End Pump)  
SAE Rating 1200 RPM-100 PSI (7 Bar)  
25 – 25 GPM    35 – 35 GPM  
30 – 30 GPM    38 – 38 GPM

**6** Mounting  
F – Foot  
Omit – Flange

**7** Shaft Type  
412 – STR. Key

**8** Outlet Port Positions  
(Viewed From Cover End Of Pump)

With No. 1 Outlet Opposite Inlet :  
AA – No. 2 Outlet – 135° CCW From Inlet  
AB – No. 2 Outlet – 45° CCW From Inlet  
AC – No. 2 Outlet – 45° CW From Inlet  
AD – No. 2 Outlet – 135° CW From Inlet

With No. 1 Outlet 90° CCW From Inlet :  
BA – No. 2 Outlet – 135° CCW From Inlet  
BB – No. 2 Outlet – 45° CCW From Inlet  
BC – No. 2 Outlet – 45° CW From Inlet  
BD – No. 2 Outlet – 135° CW From Inlet

With No. 1 Outlet Inline With Inlet :  
CA – No. 2 Outlet – 135° CCW From Inlet  
CB – No. 2 Outlet – 45° CCW From Inlet  
CC – No. 2 Outlet – 45° CW From Inlet  
CD – No. 2 Outlet – 135° CW From Inlet

With No. 1 Outlet 90° CW From Inlet :  
DA – No. 2 Outlet – 135° CCW From Inlet  
DB – No. 2 Outlet – 45° CCW From Inlet  
DC – No. 2 Outlet – 45° CW From Inlet  
DD – No. 2 Outlet – 135° CW From Inlet

**9** Design

**10** Shaft Rotation  
(Viewed From Shaft End)  
L – Left Hand (CCW Rotation)  
Omit – Right Hand (CW Rotation)

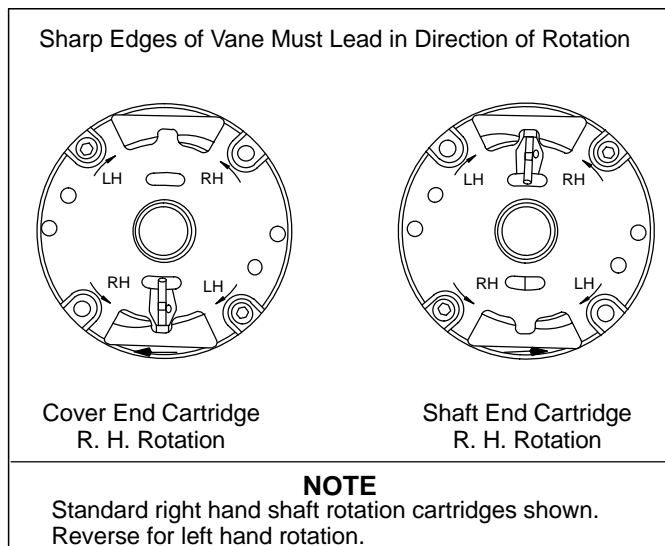

## NOTE

To reverse cartridge kit rotation, remove the two screws and reverse the location of the inlet support plate and the outlet support plate. Reinstall the two screws hand tight. Use pump cover to align all sections of the cartridge. Carefully remove the cover and tighten the screws.

When ordering spare cartridge parts, it is recommended they be obtained in cartridge kits. Kits are assembled and tested for either right or left hand rotation. If left hand rotation is required, it should be specified on parts order by adding suffix "L" to cartridge kit number.

For satisfactory service life of these components, use full flow filtration to provide fluid which meets ISO cleanliness code 18/15 or cleaner. Selections from OFP, OFR, and OFRS filter series are recommended.